

| REV | DESCRIPTION | DATE |
|------|-------------------------------|------------|
| 1.00 | INITIAL DESIGN | 2014/08/17 |
| 1.10 | NEW DRAWING FRAME | 2024/01/25 |
| 1.20 | ADD RECOMMENDED MOUNTING HOLE | 2024/08/07 |

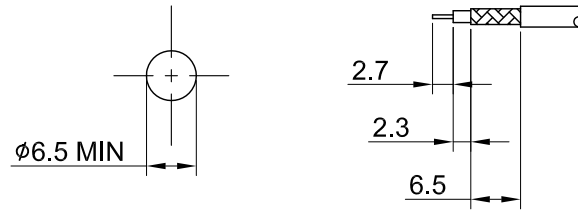

RECOMMENDED MOUNTING HOLE

RECOMMENDED STRIP LENGTHS

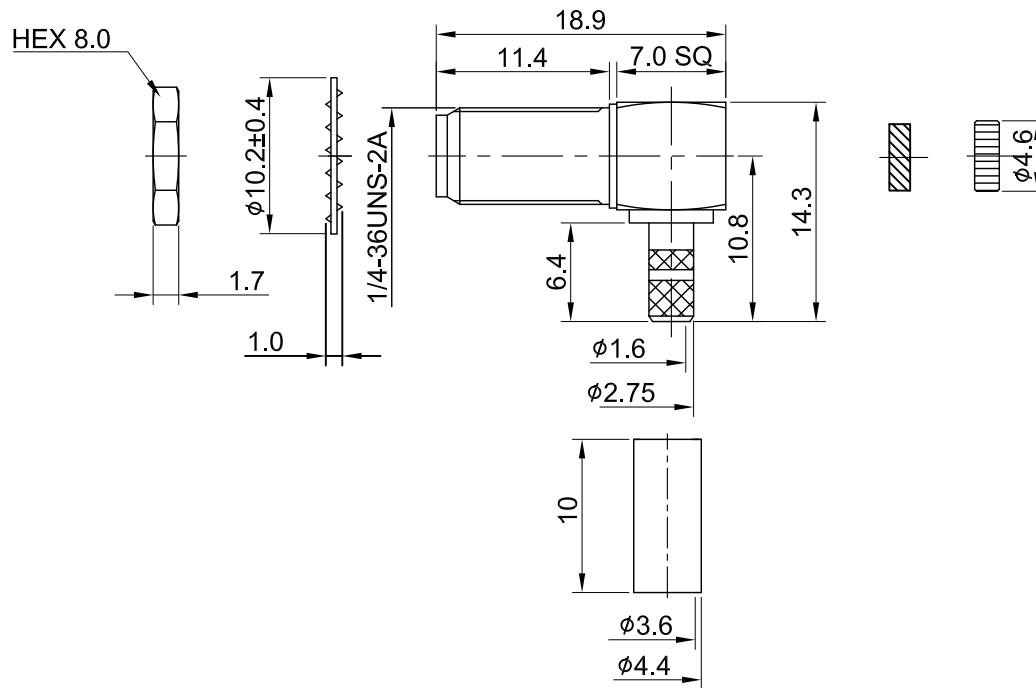

MECHANICAL DATA
 DURABILITY : 500 CYCLES
 TEMPERATURE RANGE : -65°C ~ + 165°C

ELECTRICAL DATA
 FREQUENCY RANGE: DC~6GHz
 IMPEDANCE : 50Ω
 VSWR : 1.5 MAX.
 WORKING VOLTAGE : AC 375V
 WITHSTANDING VOLTAGE : AC 750V
 INSULATION RESISTANCE : 5000 MΩ MIN

| | | | | | | |
|----|---------------|----------|--------|------|---|----------|
| 08 | FERRULE | BRASS | GOLD | 1 | TITLE SMA(F) bh. ra. crimp type for RD316 | |
| 07 | CAP | BRASS | GOLD | 1 | | |
| 06 | NUT | BRASS | GOLD | 1 | DWG NO. C02BS31316D17A | |
| 05 | WASHER | BRASS | GOLD | 1 | | |
| 04 | INSULATOR CAP | TEFLON | NONE | 1 | CUST. P/N: N/A DWG NO: N/A | |
| 03 | CENTER PIN | Be.Cu | GOLD | 1 | | |
| 02 | INSULATOR | TEFLON | NONE | 1 | GENERAL TOLERANCES .X ±0.2 .XX ±0.2 .XXX ±0.2 ANGLES N/A | |
| 01 | BODY | BRASS | GOLD | 1 | | |
| NO | DESCRIPTION | MATERIAL | FINISH | Q'TY | SHEET 1 of 1 | Unit: mm |
| | | | | | DRAWN BY: Kelly 2024/08/07 CHK'D BY: Eileen 2024/08/07 DA2408070016 | |
| | | | | | REV. 1.20 | |

