

REV	DESCRIPTION	DATE
1.30	NEW DRAWING FRAME	2023/07/25
1.31	CORRECT INSULATION RESISTANCE UNIT	2023/12/21

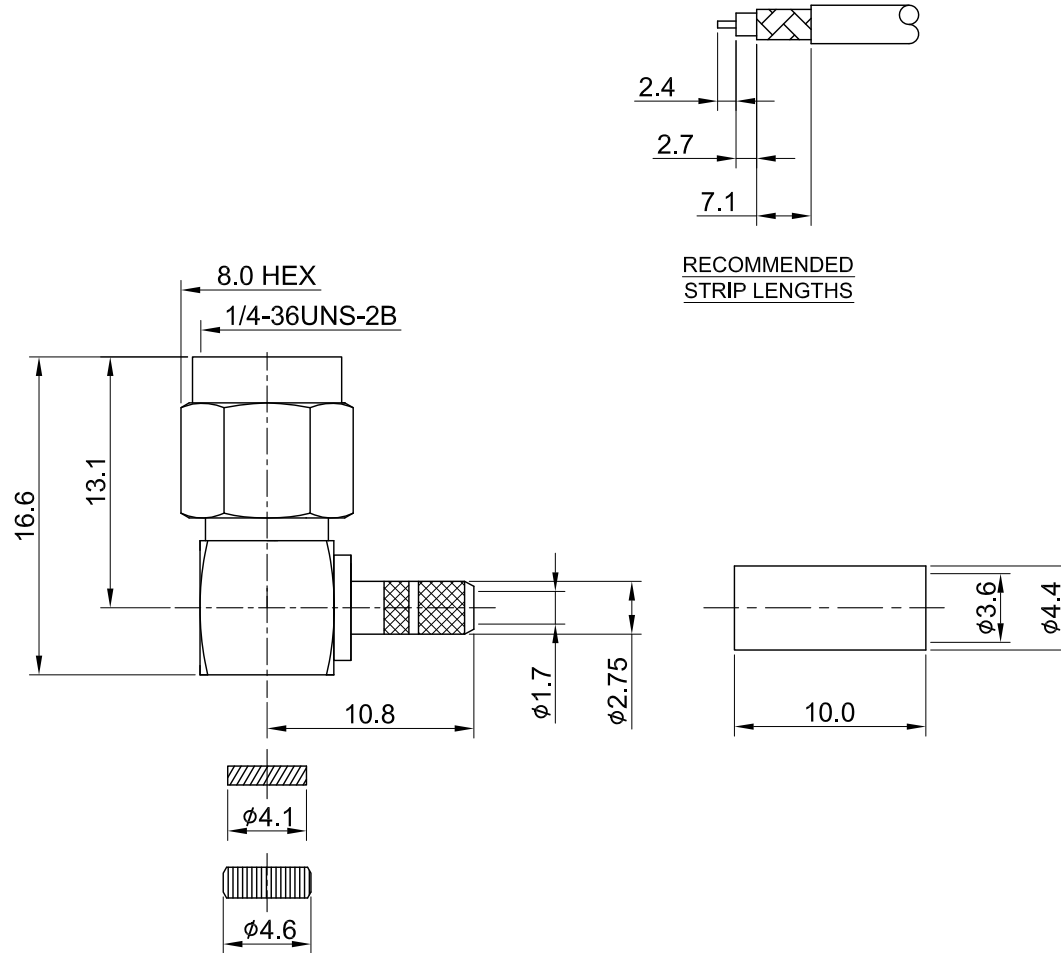

RECOMMENDED STRIP LENGTHS

09	INSULATOR B	TEFLON	NONE	1
08	CAP	BRASS	GOLD	1
07	FERRULE	BRASS	GOLD	1
06	GASKET	SILICONE RUBBER	NONE	1
05	INNER RETAINING RING	Be.Cu	NONE	1
04	SHELL	BRASS	GOLD	1
03	INSULATOR A	TEFLON	NONE	1
02	PIN	BRASS	GOLD	1
01	BODY	BRASS	GOLD	1
NO	DESCRIPTION	MATERIAL	FINISH	Q'TY

TITLE		SMA(M) ra. crimp type for RD316(press cap)									
DWG NO.		C01BA31316D08A									
CUST. P/N: N/A		DRAWN BY: Kelly 2023/12/21									
DWG NO: N/A		CHK'D BY: Eileen 2023/12/21									
SHEET 1 of 1		Unit: mm									
GENERAL TOLERANCES		<table border="0"> <tr> <td>.X</td> <td>±0.2</td> </tr> <tr> <td>.XX</td> <td>±0.2</td> </tr> <tr> <td>.XXX</td> <td>±0.2</td> </tr> <tr> <td>ANGLES</td> <td>N/A</td> </tr> </table>		.X	±0.2	.XX	±0.2	.XXX	±0.2	ANGLES	N/A
.X	±0.2										
.XX	±0.2										
.XXX	±0.2										
ANGLES	N/A										
DA2312180028		REV. 1.31									

MECHANICAL DATA
TEMPERATURE RANGE : -65°C ~ + 165°C

ELECTRICAL DATA
FREQUENCY RANGE: DC~6GHZ
IMPEDANCE : 50Ω
VSWR : 1.5 MAX.
WORKING VOLTAGE : AC 375V
WITHSTANDING VOLTAGE : AC 750V
INSULATION RESISTANCE : 5000 MΩ MIN

