

REV	DESCRIPTION	DATE
1.20	CHG INSULATOR COVER PET W. POM	2023/08/22
1.30	CORRECT INSULATION RESISTANCE	2023/11/09

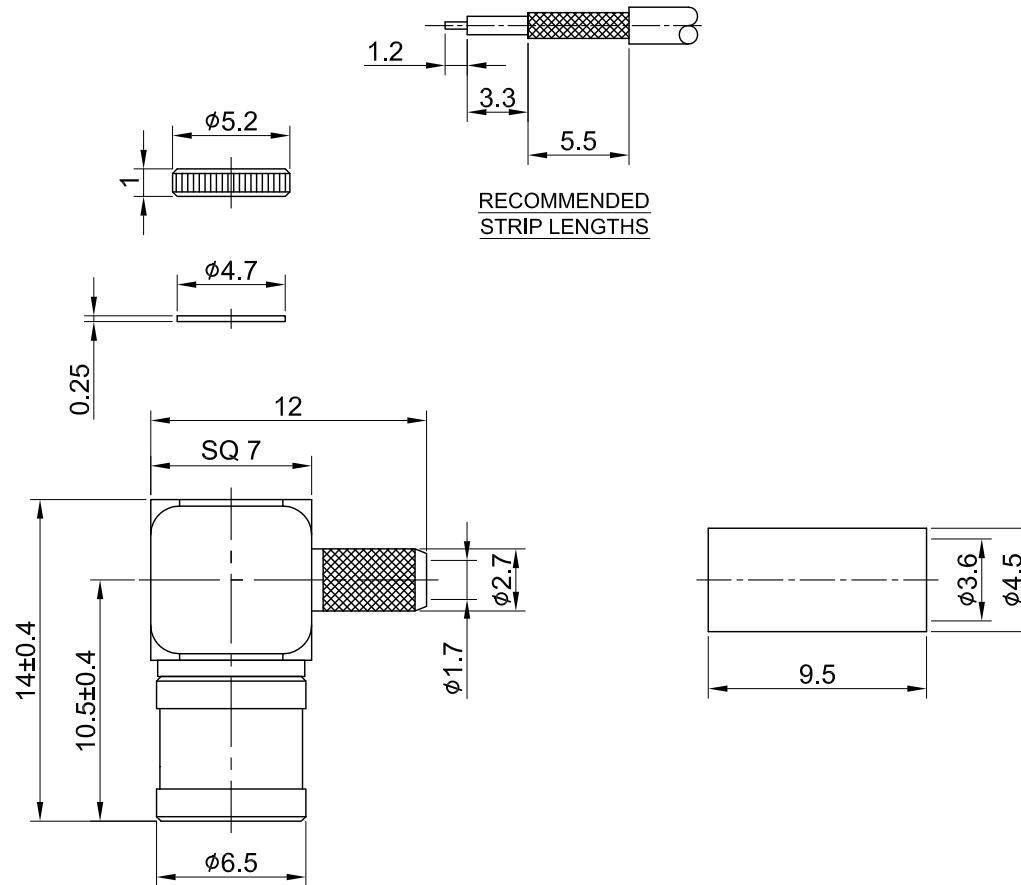

MECHANICAL DATA  
 DURABILITY : 500 CYCLES  
 TEMPERATURE RANGE : -40°C ~ + 85°C

ELECTRICAL DATA  
 FREQUENCY RANGE: DC~4GHz  
 IMPEDANCE : 50Ω  
 VSWR : 1.5 MAX.  
 WORKING VOLTAGE : AC 335V  
 WITHSTANDING VOLTAGE : AC 750V  
 INSULATION RESISTANCE : 1000 MΩ MIN

09	FERRULE	BRASS	GOLD	1
08	PRESS WASHER	BRASS	GOLD	1
07	INSULATOR COVER	PET	NONE	1
06	SQ BODY	BRASS	GOLD	1
05	PIN	Be.Cu	GOLD	1
04	INSULATOR	TEFLON	NONE	1
03	BODY	BRASS	GOLD	1
02	SHELL	BRASS	GOLD	1
01	C RING	Be.Cu	GOLD	1
NO	DESCRIPTION	MATERIAL	FINISH	Q'TY

TITLE		DRAWN BY: Lottie		2023/11/09
SMB(M) ra. crimp type for RD316		CHK'D BY: Dora		2023/11/09
DWG NO. C03BA3F316D01-1		GENERAL TOLERANCES		
CUST. P/N: N/A DWG NO: N/A		.X ±0.2 .XX ±0.2 .XXX ±0.2 ANGLES N/A		
SHEET 1 of 1		Unit: mm		DA2311060024 REV. 1.30