

REV	DESCRIPTION	DATE
1.00	INITIAL DESIGN	2017/08/03
1.10	CHG 1.7 W. 2.6, INSULATOR A PET W. POM	2023/05/18
1.11	UPDATE TEMPERATURE RANGE	2023/08/04
1.20	CORRECT INSULATION RESISTANCE	2023/11/08

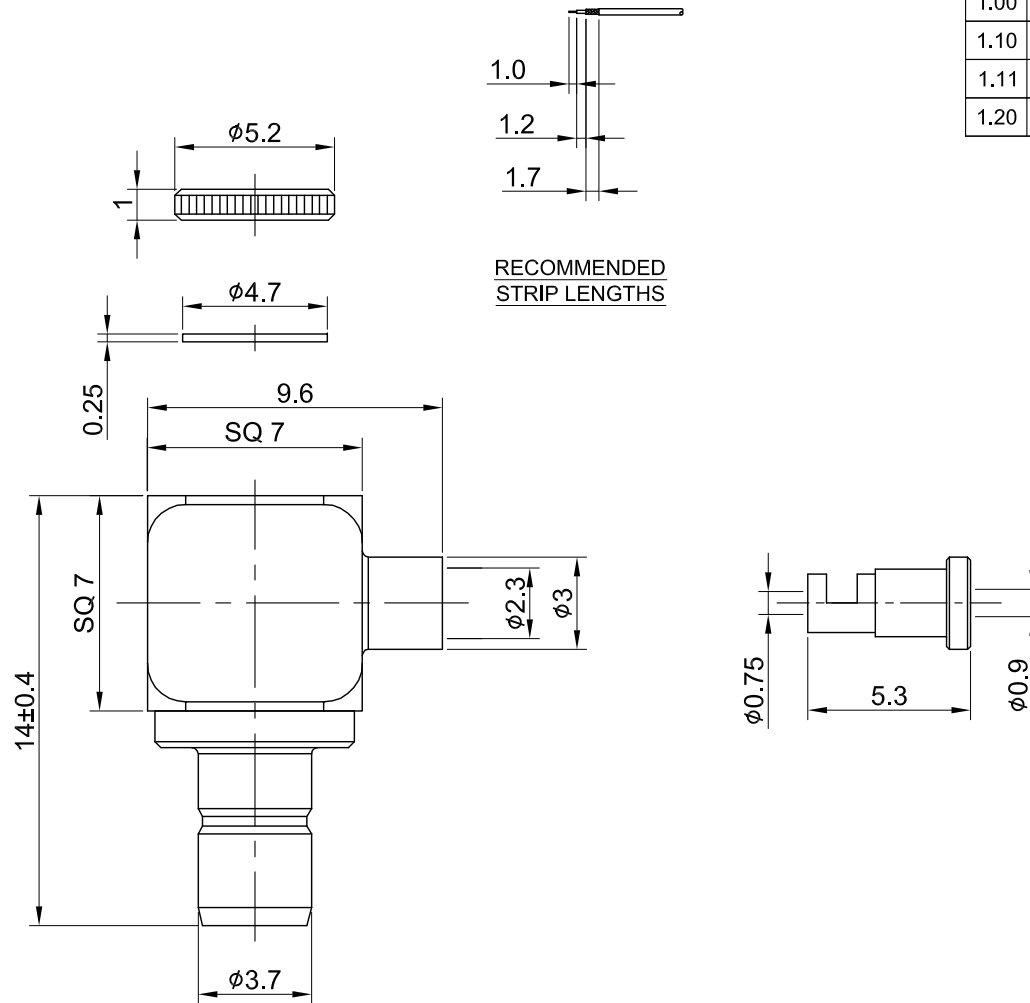

MECHANICAL DATA  
TEMPERATURE RANGE : -40°C ~ + 85°C

DIELECTRICAL DATA  
FREQUENCY RANGE: DC~4GHz  
IMPEDANCE : 50Ω  
VSWR : 1.5 MAX.  
WORKING VOLTAGE : AC 335V  
WITHSTANDING VOLTAGE : AC 750V  
INSULATION RESISTANCE : 1000 MΩ MIN

07	FERRULE	BRASS	GOLD	1
06	BODY B	BRASS	GOLD	1
05	INSULATOR B	TEFLON	NONE	1
04	CENTER PIN	BRASS	GOLD	1
03	BODY A	BRASS	GOLD	1
02	INSULATOR A	PET	NONE	1
01	COVER	BRASS	GOLD	1
NO	DESCRIPTION	MATERIAL	FINISH	Q'TY

TITLE		DRAWN BY:	
SMB(F)ra. crimp for 0.81		Lottie	2023/11/08
DWG NO.		CHK'D BY:	
C04BA3F081011A		Kana	2023/11/08
CUST.		GENERAL TOLERANCES	
P/N: N/A		.X	±0.2
DWG NO: N/A		.XX	±0.2
		.XXX	±0.2
		ANGLES	N/A
SHEET		REV.	
1 of 1	Unit: mm	DA2311060017	1.20

