

REV	DESCRIPTION	DATE
4.10	NEW DRAWING FRAME	2023/08/30
4.11	CORRECT INSULATION RESISTANCE UNIT	2023/11/08

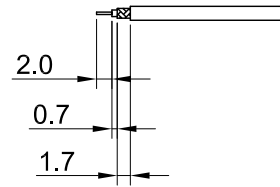

RECOMMENDED STRIP LENGTHS

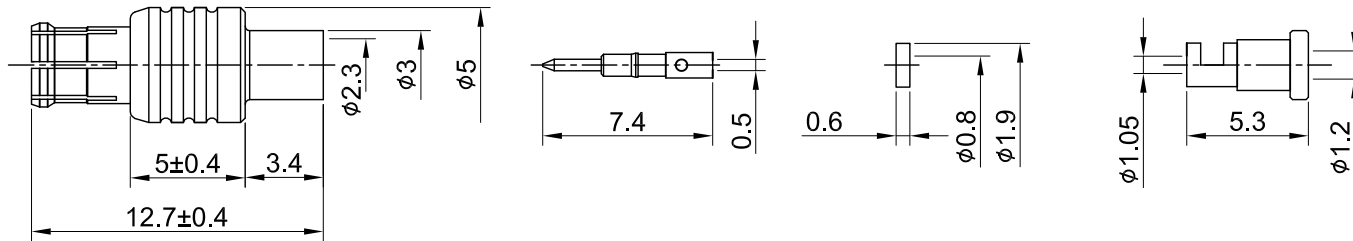

MECHANICAL DATA  
TEMPERATURE RANGE : -65°C ~ + 165°C

ELECTRICAL DATA  
FREQUENCY RANGE: DC~6GHZ  
IMPEDANCE : 50Ω  
VSWR : 1.3 MAX.  
WORKING VOLTAGE : AC 335V  
WITHSTANDING VOLTAGE : AC 500V  
INSULATION RESISTANCE : 1000 MΩ MIN

06	FERRULE	BRASS	GOLD	1
05	GASKET	TEFLON	NONE	1
04	BODY B	BRASS	GOLD	1
03	CENTER PIN	BRASS	GOLD	1
02	INSULATOR	TEFLON	NONE	1
01	BODY A	Be.Cu	GOLD	1
NO	DESCRIPTION	MATERIAL	FINISH	Q'TY

TITLE		DRAWN BY:		CHK'D BY:		REVISION	
MCX(M) st. for 1.13/1.13LL		Kelly		Eileen		REV.	
DWG NO. C07AA31113004A		2023/11/08		2023/11/08		4.11	
CUST. P/N: N/A DWG NO: N/A		DRAWN BY: Kelly		CHK'D BY: Eileen		REVISION: 4.11	
SHEET 1 of 1 Unit: mm		DA2311080013		2023/11/08		4.11	



GENERAL TOLERANCES		DRAWN BY:		CHK'D BY:		REVISION	
.X	±0.2	Kelly		Eileen		REV.	
.XX	±0.2	2023/11/08		2023/11/08		4.11	
.XXX	±0.2						
ANGLES	N/A						