

REV	DESCRIPTION	DATE
1.00	INITIAL DESIGN	2020/12/17
1.10	NEW DRAWING FRAME	2023/11/06

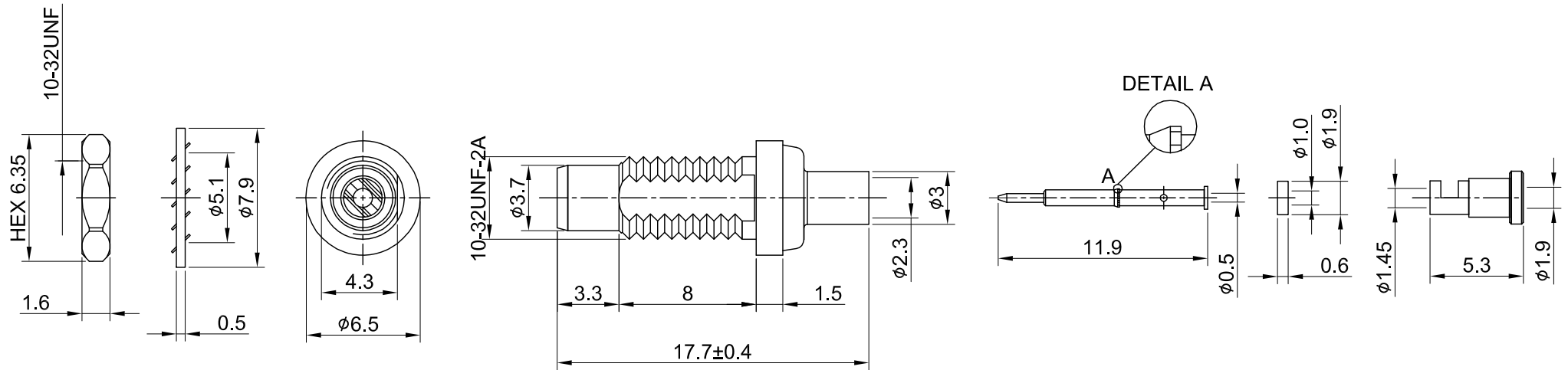
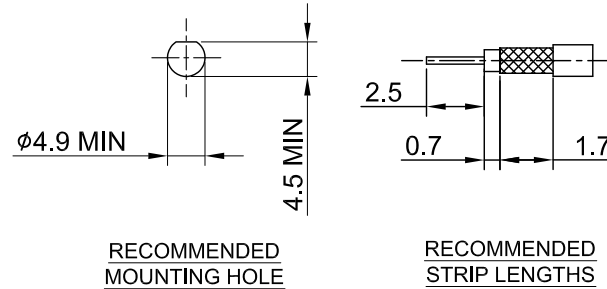

MECHANICAL DATA  
TEMPERATURE RANGE : -65°C ~ + 165°C

ELECTRICAL DATA  
FREQUENCY RANGE: DC~6GHz  
IMPEDANCE : 50Ω  
VSWR : 1.5 MAX.  
WORKING VOLTAGE : AC335V  
WITHSTANDING VOLTAGE : AC 750V  
INSULATION RESISTANCE : 1000 MΩ MIN

08	NUT	BRASS	GOLD	1	TITLE SMC(F) st. bh. crimp type for RG178					
07	WASHER	BRASS	GOLD	1						
06	FERRULE	BRASS	GOLD	1						
05	INSULATOR GASKET	TEFLON	NONE	1	DWG NO. C14AB3F178006E		DRAWN BY: Kelly 2023/11/06			
04	CENTER PIN	BRASS	GOLD	1	CUST. P/N: N/A DWG NO: N/A		CHK'D BY: Eileen 2023/11/06			
03	BODY B	BRASS	GOLD	1					REV.	
02	INSULATOR	TEFLON	NONE	1					DA2311060008	
01	BODY A	BRASS	GOLD	1	SHEET 1 of 1 Unit: mm					
NO	DESCRIPTION	MATERIAL	FINISH	Q'TY						

GENERAL TOLERANCES		DRAWN BY: Kelly 2023/11/06	
.X	±0.2	CHK'D BY: Eileen 2023/11/06	
.XX	±0.2		
.XXX	±0.2		
ANGLES	N/A	REV. 1.10	