

REV	DESCRIPTION	DATE
1.11	CORRECT TITLE JACK W. PLUG	2017/02/06
1.20	NEW DRAWING FRAME	2024/01/04

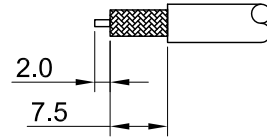

RECOMMENDED  
STRIP LENGTHS

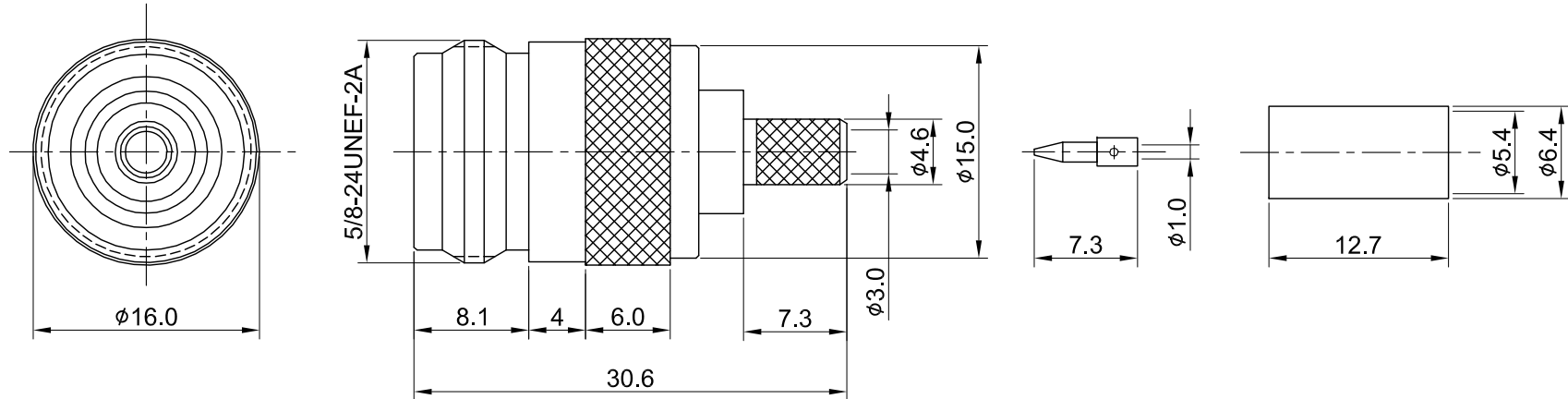

MECHANICAL DATA  
TEMPERATURE RANGE : -65°C ~ + 165°C

ELECTRICAL DATA  
FREQUENCY RANGE: DC~6GHz  
IMPEDANCE : 50Ω  
VSWR : 1.35 MAX.  
WORKING VOLTAGE : AC 1000V  
WITHSTANDING VOLTAGE : AC 2500V  
INSULATION RESISTANCE : 5000 MΩ MIN

03	FERRULE	BRASS	NICKEL	1
02	BULLET CONTACT	BRASS	GOLD	1
01	CENTER PIN	P.BRONZE	GOLD	1
	INSULATOR	TEFLON	NONE	1
	BODY	BRASS	NICKEL	1
NO	DESCRIPTION	MATERIAL	FINISH	Q'TY

TITLE		DRAWN BY:		CHK'D BY:	
N(F)st.crimp for RG58		Kelly		Maria	
DWG NO. C28CA31058A04A		2024/01/04		2024/01/04	
CUST. P/N: N/A DWG NO: N/A		GENERAL TOLERANCES		REV.	
SHEET 1 of 1 Unit: mm		.X ±0.2 .XX ±0.2 .XXX ±0.2 ANGLES N/A		DA2312270080 2.10	

